

DAILY VASO DA002BI

CE EN 997:2015

GLOBO

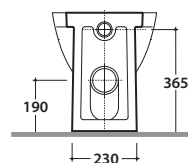
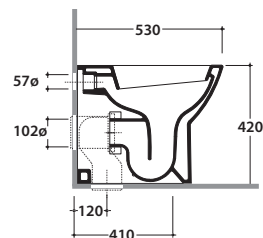
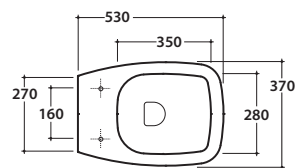

Effetto antibatterico su ceramica BATAFORM®
Ceramic antibacterial effect BATAFORM®



Scarico ottimizzato a 4/2,6 litri
Drain 4/2,6 lt



Prodotto smaltato con CERASLIDE®
Glazed product with CERASLIDE®

Cod. **DA002BI**

Vaso a terra 53.37 h42 cm. Installazione filo parete. Scarico 4 / 2,6 Lt. Completo di fissaggi. Peso 26 Kg
Floor mounted Wc 53.37 h42 cm. Back to wall installation Drain 4/2,6Lt. Fixing kit included. Weight 26 Kg



Coprivaso con sistema di cerniere a sgancio rapido
Seat-cover with hinge system to quick release



Trattamento antibatterico per sedili in versione bianco lucido
Antibacterial treatment on toilet seats in shiny white

Cod. **DAR19BI**

Coprivaso rimovibile in duroplast con chiusura tradizionale. Peso 3 Kg
Removable duroplast seat-cover with traditional closing system. Weight 3 Kg

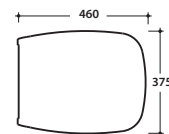

Cod. **DAR20BI**

Coprivaso rimovibile in duroplast con chiusura rallentata. Peso 3 Kg
Removable duroplast seat-cover with soft-closing system. Weight 3 Kg

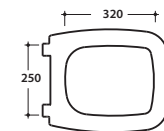

Cod. **VA079**

Curva tecnica per lo scarico a pavimento regolabile da 13 a 15 cm . Peso 0,3Kg
Elbow pipe for floor drain. Adjustable 13/15 cm. Weight 0,3 Kg

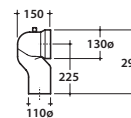

Cod. **VA076**

Raccordo per scarico a parete cm. 35
Pipe for wall drain 35cm



Cod. **VA132**

Riduttore flusso di scarico.
Flow reductor.